

BUSINESS, MEETINGS, CORPORATE AND TEAM WELLBEING EVENTS



DUE TO COVID-19 AND TO **SAVE TREE'S** BY NOT
REPRINTING BROCHURES WE NEVER USED,
WE'VE KEPT OUR 2020 BROCHURE WITH ALL
PRICES FROZEN FROM 2020
SO...
BOOK YOUR PARTY FOR 2021

NORTH WEST CENTRE FOR
BUSINESS & TEAM



No other venue offers our unique combination of
sustainability, fun and wellbeing...

CORPORATE HIRE AT THE NORTH WEST CENTRE FOR BUSINESS AND TEAM WELLBEING

Inspire your health, business and mind

Do you want a venue which ticks the following boxes all at the same time?

- » Fantastic space for your strategic planning/corporate away day which stimulates creative thinking,
- » Contributes to your staff wellbeing,
- » Amazing food with a specially designed, nutritionally balanced menu,
- » Highlights your company's commitment to meeting sustainability and environmental targets, enhancing CSR,
- » Flexible spaces for creativity and brainstorming sessions, strategic decision making and fun team building activities.

We offer all this and much more!

BOOK NOW... 01204 852 113







THE PERFECT VENUE



The North West Centre for Business and Team Wellbeing is a fresh, innovative new venue for your company's next event, be it a meeting, training, corporate away day, or something completely different! Located in the heart of the beautiful North West countryside, the primary focus of our farm-based venue is the wellbeing of your staff and clients.

Offering the perfect blend of eco-friendliness, peace and cutting-edge meeting facilities allowing you to focus, energise and inspire.

Our vast outdoor space is ideal for team building and exploring so we feel it would be wrong of us if we didn't incorporate nature into our corporate offer. Our natural setting and aesthetics have created an environment **which guides the mind to be creative**. It is perfect for reflection and innovative thinking whilst challenging the dynamics, strengths and structure of your team.

We offer **two high class meeting facilities and four breakout areas** to choose from and all are equipped with state-of-the-art audio-visual equipment, free Wi-Fi internet and plenty of plug sockets.

You will also be provided with **free on-site secure car parking**, great food, great coffee and your very own dedicated event manager.





Here at the North West Centre for Business and Team Wellbeing we work hard to accommodate your every need. Our Wellbeing Hub feature enables you to achieve the best outcome for your team during your event.

The North West Centre for Business and Team Wellbeing partners with www.WellbeingLancashire.org.uk to bring you some of the best wellbeing providers in the North West to make a truly unique event that is engaging, informative and fun.

Here is our commitment to you for your very own tailored and bespoke event...

Food to fuel your mind - Teaming up with our very own award winning butchers and chefs, our bespoke menus work with nature and the rhythms of the seasons to provide you with delicious, local and seasonal food, providing a true taste of Lancashire.



Sustainability - Committed to providing a high quality service, whilst minimising the impact of our activities on the environment. We have achieved the highest award in sustainable venues achieving the **Gold level Green Tourism Scheme accreditation** from the world's leading sustainable certification programme for the tourism sector. We do our best to help the environment by recycling, composting, reducing water usage and energy consumption. From sourcing as much as possible from local firms to creating 'green' fuel from waste, we are always looking for inventive ways to improve our sustainability.





Meeting spaces - The flexible environments and resources available to hire (both indoor and outdoor) can be tailored to suit your needs. Whether it is a workshop to develop skills, a giant set of outdoor games, or a staff party to remember, our venue offers the perfect mixture of creative space and fun.

Party - We are the perfect venue for bespoke corporate events from presentations to award ceremonies and Christmas parties. Escape from the ordinary and celebrate with your team by working with us to create a magical event at the farm.

Event Coordination - Our dedicated team will answer any queries quickly and be on hand throughout your event to make sure that everything runs to your specifications.



Safety and facilities - Our comfortable, safe and spacious facilities have been redesigned to fit around social distancing restrictions and we are a Covid-19 secure venue and we give your safety our highest priority in these unprecedented times. In fact we've even developed a '**Safe Meetings and Events Promise**' based around the following areas:



- » **Covid-19 secure** - our venue can safely operate social distancing due to our vast amount of outdoor space, fresh air, clear signage and with controlled access,
- » Our staff are trained in Covid-19 standards and food hygiene and new operational procedures are in place,
- » Cleanliness and hygiene - our venue has NHS standard sanitising equipment, hand sanitisers and new and improved cleaning procedures,
- » Our award winning events team will keep you regularly informed on safety matters throughout the planning of your event,
- » Embracing technology - we can assist with live streaming and video conferencing and we provide virtual tours,
- » Contact free catering - for your safety, we offer bespoke pre-packaged food and drink prepared on site using fresh local ingredients.





Wheatsheaf Barn

Room dimensions are shown in the image on the right

- » Seats up to 42 people
- » Dual aspect double doors with plenty of natural light and great views of the local countryside
- » 55" LED television with wall-based audio-visual input
- » Reliable Wi-Fi
- » Office facilities
- » Disabled access – ground floor setting
- » Three phase power supply
- » 16 plug sockets
- » Cloakroom

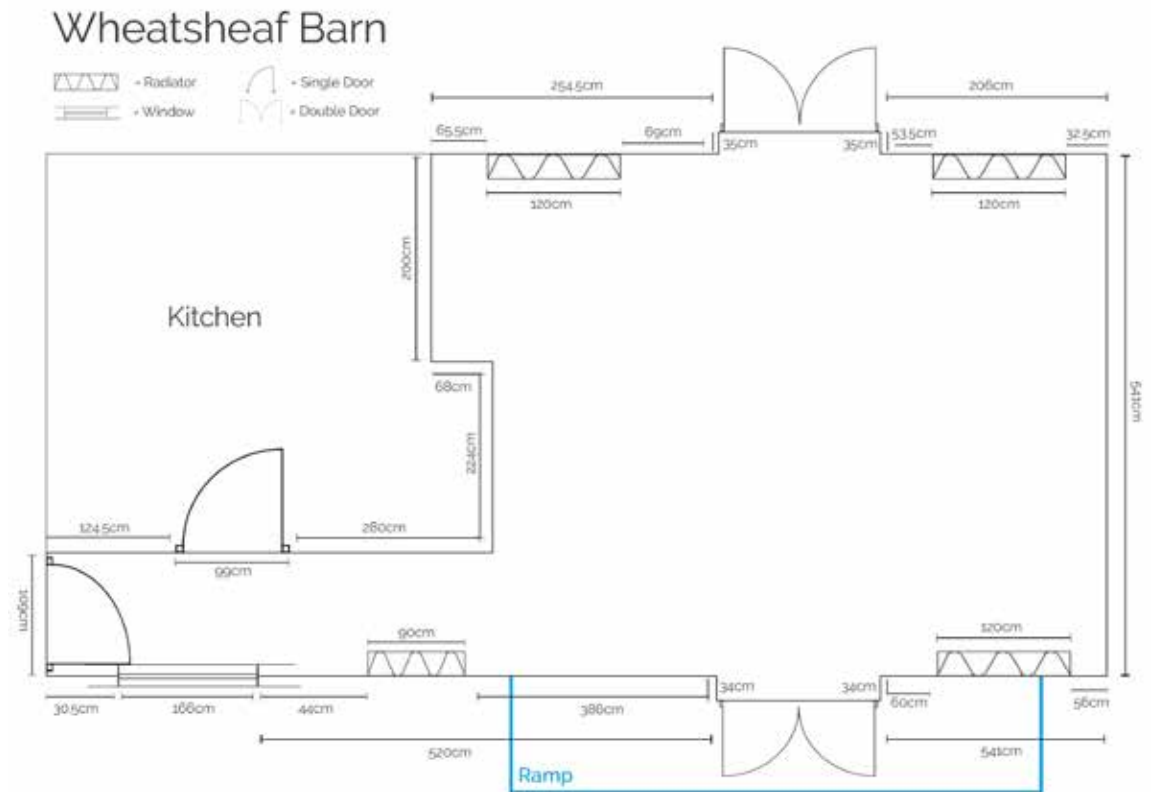

Events Barn

Room dimensions are shown in the image on the right

- » Seats up to 180 people and 300 standing
- » Plenty of natural light
- » Numerous doors allowing plenty of fresh air to flow through the room
- » Screen and LCD projector
- » Staging
- » Uplighting
- » Reliable Wi-Fi
- » Office facilities
- » Disabled access – ground floor setting
- » Exhibition space
- » Three phase power supply
- » 42 plug sockets

Events Barn





Wheatsheaf Bar seats up to 30

Licensed bar, coffee area, television for presentations and plenty of natural daylight - a great area for mingling and networking over coffee or something stronger!



Event Barn Bar seats up to 30

Fully licensed bar, Brew Station (help yourself to complimentary coffee), television for presentations and comfy sofas with plenty of natural daylight. A magical space for connecting, communication and having fun.



Outdoor Pavilion seats up to 8

With comfy cushions and circular seating for the ultimate creative space.



The snug seats up to 6

Coffee area, comfy chairs, television for presentations and inspiring views.





Offering excellent value, we aim to provide a unique and tailored experience for your event.

The best way to discuss how the North West Centre for Business and Team Wellbeing can help your organisation is to contact us at info@thewellbeingfarm.co.uk or better still, call us on 01204 852 113.

Our day delegate rate includes:

- » Welcome tea/coffee with a selection of biscuits
- » Working grazing table lunch (Covid-19 single-serve)
- » Afternoon tea/coffee with farmhouse cake
- » Full audio-visual equipment, screens or projector and flipchart with pens
- » Pads, pens, bottles of water, cordials and mints
- » Free Wi-Fi – wireless internet access
- » Live streaming
- » Access to secure car park fitting 100 cars
- » Dedicated Event Manager to assist you throughout the planning and delivery of your event
- » Business services

Pricing – day delegate package ***(9:00am - 6:00pm) (prices exclude vat)***

Number of Delegates	Wheatsheaf Barn (rate per delegate)	Events Barn (rate per delegate)
0-10	£47.50	
11-20	£42.50	
21-30	£38.50	
31-40	£35.50	
41-50		£35.50
51-70		£32.50
71+		£30.00

Our delegate commitment to you:

Prior to your event we will...

- » Respond to your enquiries promptly
- » Aid you throughout planning your event
- » Liaise with you to finalise arrangements

On arrival we will...

- » Meet and greet your trainer or named contact for the event
- » Ensure the space is ready and meets your requirements in terms of layout, facilitation equipment, IT requirements, refreshments etc

During your event we will...

- » Refresh your meeting room at main break times
- » Respond in a timely manner to requests for changes or additional requirements
- » Provide an effective business facility with access to black and white or colour photocopying, email facilities, telephone and fax facilities

Additional Charges (Prices exclude vat)

Exclusive use of the whole Farm (10am-6pm)	£2000
Hire of stage	£200
Hire of PA system	£75
Hire of uplighters	£75
Outdoor games	£150
Breakout facilities charges	up to £150
Early morning opening (7:30-9:00am) with breakfast sandwiches	£300 + £3.50pp



An assurance of excellence in
business meetings and events
Service. Safety. Health. Responsibility.



BOOK NOW... 01204 852 113

WHAT ABOUT A WOW FACTOR CORPORATE PARTY?



Why not hire The North West Centre for Business and Team Wellbeing on an exclusive basis? We are perfect for bespoke corporate events with enough space for up to 160 guests seated and 300 for a party. With bespoke menus and a whole range of drinks and entertainment, you can escape from the ordinary and celebrate with your team by working with us to create a magical event at the farm.

During the day

Why not entertain your crew with activities designed with fun in mind, to bond, strengthen and consolidate your team. We have ample space for you to use for a whole host of indoor and outdoor games including:

- » Hiring inflatable obstacle courses
- » Team building challenges
- » Activities to test communication and creative thinking

With our flexible spaces you will struggle to find something we can't do here! You may like to try:

- » Enjoy mingling with the Llamas, make some cocktails, even host your own staff award ceremony



- » Put your team to the test by running activities to guide their communication and problem solving skills
- » Strategic thinking sessions followed by a relaxing afternoon of fun activities to reward staff
- » A wellbeing workshop to keep your team in the best of health and enhance productivity giving you access to our network of approved wellbeing providers.

Into the evening

We can cook your team a bespoke feast designed by our Head Chef and then get your dancing shoes on and enjoy your favourite tunes and entertainment until 1am. We have a fully stocked bar, with local gins and even help-yourself beer!

Our Events Team can assist in planning your corporate party with the WoW Factor.

Give us a call on 01204 852 113 or email at info@thewellbeingfarm.co.uk so we can have a chat and start your planning.

Don't forget we are also the perfect venue for your unique Christmas Party!



CHRISTMAS AT THE NORTH WEST WELLBEING CENTRE



Book with Confidence – Our Commitment to your safety

Here at the North West Centre for Business and Team Wellbeing, we value the wellbeing of our event guests, event organisers, suppliers, visitors and staff above all else. You and your delegates need to feel safe in our spaces and confident in our staff and services and this is our number one priority. It's this mantra that has earned us multiple industry awards and accreditation with the Meeting Industry Association.

The landscape of events is changing. Although the way we do things might not be the same, and in some instances from a distance, to what we're used to, rest assured that you are in safe (and sanitized) hands.

Our fantastic team will work to provide a successful and memorable event for you and your guests.

Our Event Guarantee – Flexible Bookings

We know that you will have concerns about booking events in a world where day-by-day anything can change what you have planned. We want to put your mind at ease by introducing a flexible approach to bookings.

For any new meetings, events or Christmas Party bookings confirmed with us moving forwards, we promise that should they subsequently be unable to go ahead due to COVID-19 we will transfer your booking to a mutually agreeable future date penalty-free. As an added assurance we will make no change to the previously agreed rates.

CORONAVIRUS
BOOK WITH
CONFIDENCE
Guarantee



OUR SIX POINT PLAN



We have implemented social distancing measures, cleaning procedures and protective practices to ensure our venue is safe to deliver events for guests and staff in relation to Covid-19. We have devised our plan using feedback from our clients, couples and industry research. This plan outlines our strategy in six key themes laid out below:

1. Social distancing and space
2. Cleanliness and hygiene
3. Contact free catering
4. Enhanced technology
5. Communication and stress free planning
6. Delivering your event outcomes

This strategy will continue to grow and adapt alongside emerging government protocols and in compliance with hospitality industry standards and best practice.

We will keep regular communication with couples and clients and information will be regularly updated and readily available on our websites at www.thewellbeingfarm.co.uk and www.northwestwellbeingcentre.co.uk and also within our fortnightly Llama Drama newsletter.





SOCIAL DISTANCING AND SPACE

We have introduced strict social distancing measures that minimise transmission and protect all individuals. We have one-way systems throughout our venue, no narrow corridors, large amounts of space indoors and outdoors and no carpets.



CLEANLINESS AND HYGIENE

We will maintain diligence in cleanliness and have introduced increased hygiene measures. A Covid-19 secure risk assessment has been implemented and we are following Government guidance, as and when it is issued.



CONTACT FREE CATERING

The way we serve food will change but the delicious taste remains. We will deliver the same quality food and drink with increased safety and minimal contact.

Delegates can choose from a selection of pre-packed delicious lunch boxes which are a smart and hygienic alternative to traditional plated meals and buffets. Lunch boxes are served with individual biodegradable cutlery and we will provide individually bottled water for delegates on meeting tables.

We have created a cashless environment to reduce contact.



ENHANCED TECHNOLOGY

We will help you with video conferencing solutions, live streaming and virtual tours.

Whatever option you choose, our dedicated events team will be on hand to provide advice and guidance to maximise how you use our equipment for your event.



COMMUNICATION AND STRESS FREE PLANNING

We will ensure you of regular communication and updates from our team throughout your booking and event planning experience.

Prior to your event you will be sent an event planner pack, which will include advice for delegates detailing our new safety measures and guidance.



DELIVERING YOUR EVENT OUTCOMES

No other venue offers our unique combination of sustainability, fun and wellbeing.

Our flexible, sustainable and safe award winning venue offers you and your team the ultimate experience in facilitation, wellbeing, team building and fun.

ACCOMMODATION & TRAVELLING



Accommodation:

Our luxury Farmhouse sleeps up to six adults and includes continental breakfast.

We can also provide a full list of local accommodation and taxi services, should more of your party wish to stay the night locally.

How to Find us:

Wheatsheaf Hill Farm, Plantation Road,
Edgworth, Lancashire BL7 0BY

Located within 5 miles of junction 5 of the M65, close to feeder routes for the M61, M55, M60, M6, we have plenty of on-site parking. For a greener option, why not travel to Manchester Victoria, board the Clitheroe train and in approximately 27 minutes you will arrive at Bromley Cross station where a taxi to the farm will cost you no more than £10. There are also similar direct trains from Blackburn Station.



Get The Wellbeing Experience

The best way to really understand what we can offer is to visit us to get the full 'wellbeing experience'.

How To Contact Us:

Email: info@thewellbeingfarm.co.uk

Telephone: 01204 852 113

Book a visit: <https://thewellbeingfarm.youcanbook.me/>



NORTH WEST CENTRE FOR
BUSINESS & TEAM



www.northwestwellbeingcentre.co.uk